

Easley Associates Architects  
Enid, OK  
223 N. Independence



2012 ALTERATIONS TO  
MONROE ELEMENTARY SCHOOL  
400 WEST COTTONWOOD  
INDEPENDENT SCHOOL DISTRICT NO. 57  
500 SOUTH INDEPENDENCE ENID, OKLAHOMA



DATE: 02/14/2012  
REV.:

A8.1  
OF 19

NOTE:  
ALL NEW DOWNSPOUTS IN THIS AREA SHALL CONNECT TO NEW BELOW-GRADE DRAINAGE SYSTEM. COORDINATE NEW 5"x5" D.S. LOCATIONS, ETC. WITH EXISTING OPENINGS & BELOW-GRADE DRAINAGE CONTRACTOR (SEE CIVIL).

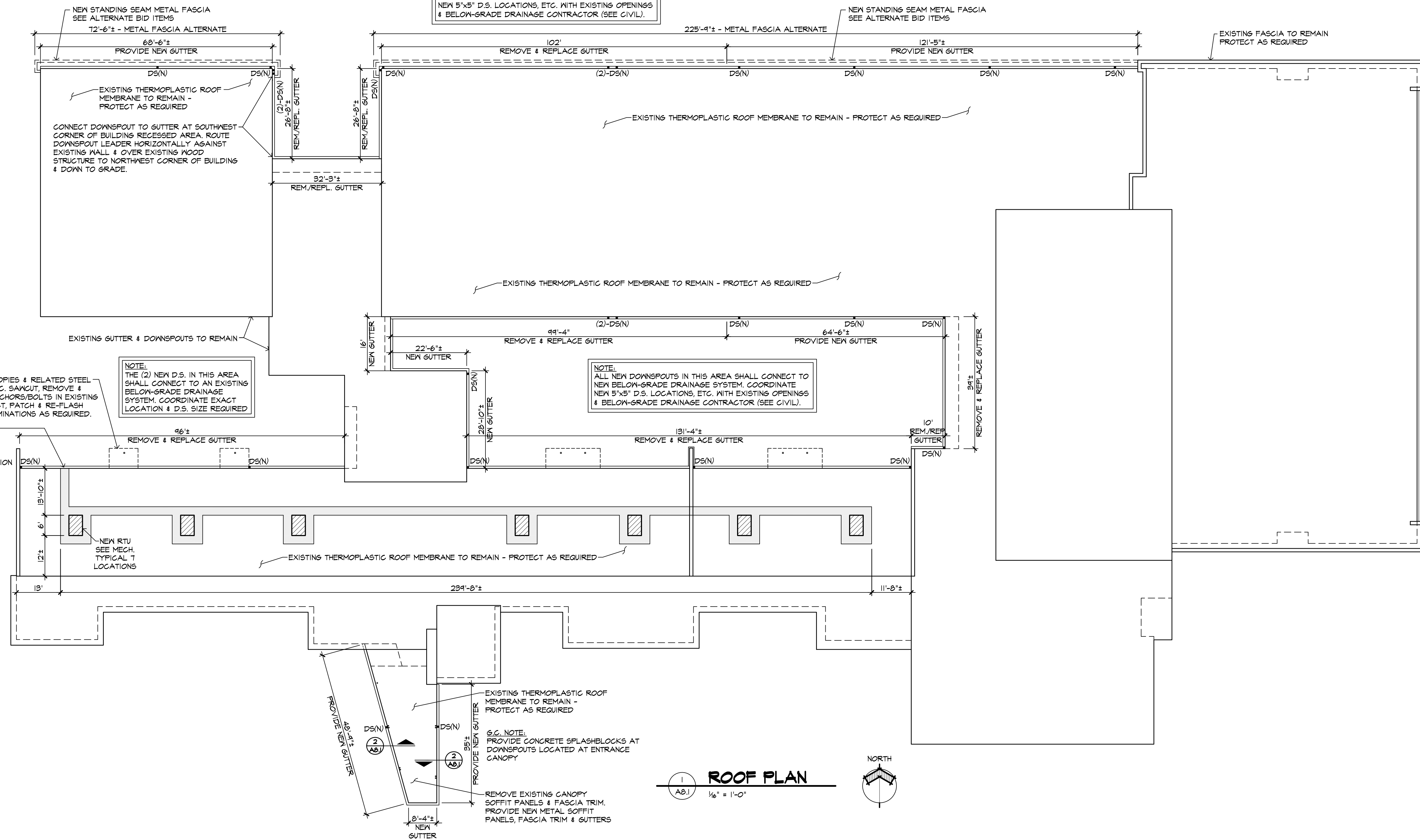

1 ROOF PLAN  
1/8" = 1'-0"  
NORTH

REMOVE (4) EXISTING CANOPIES & RELATED STEEL COLUMNS, BASEPLATES, ETC. SAWCUT, REMOVE & PATCH ANY EMBEDDED ANCHORS/BOLTS IN EXISTING CONCRETE SLABS. PROTECT, PATCH & RE-FLASH EXISTING ROOF EDGE TERMINATIONS AS REQUIRED.

NOTE:  
THE (2) NEW D.S. IN THIS AREA SHALL CONNECT TO AN EXISTING BELOW-GRADE DRAINAGE SYSTEM. COORDINATE EXACT LOCATION & D.S. SIZE REQUIRED.

NOTE:  
ALL NEW DOWNSPOUTS IN THIS AREA SHALL CONNECT TO NEW BELOW-GRADE DRAINAGE SYSTEM. COORDINATE NEW 5"x5" D.S. LOCATIONS, ETC. WITH EXISTING OPENINGS & BELOW-GRADE DRAINAGE CONTRACTOR (SEE CIVIL).

EXISTING THERMOPLASTIC ROOF MEMBRANE TO REMAIN - PROTECT AS REQUIRED  
6.C. NOTE:  
PROVIDE CONCRETE SPLASHBLOCKS AT DOWNSPOUTS LOCATED AT ENTRANCE CANOPY  
REMOVE EXISTING CANOPY SOFFIT PANELS & FASCIA TRIM. PROVIDE NEW METAL SOFFIT PANELS, FASCIA TRIM & GUTTERS

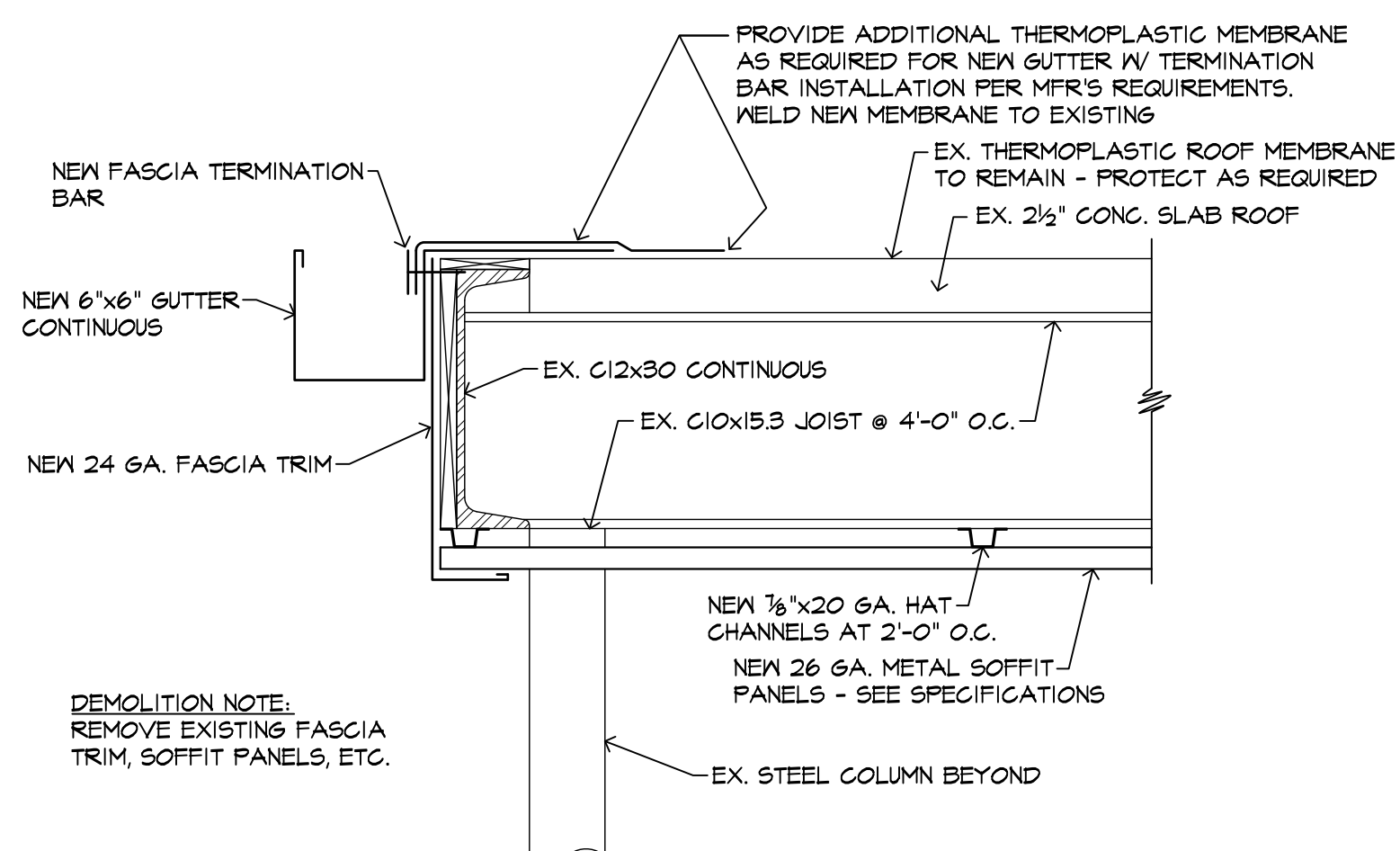

2 CANOPY FASCIA/SOFFIT SECTION  
1/2" = 1'-0"

DEMOLITION NOTE:  
REMOVE EXISTING FASCIA TRIM, SOFFIT PANELS, ETC.